

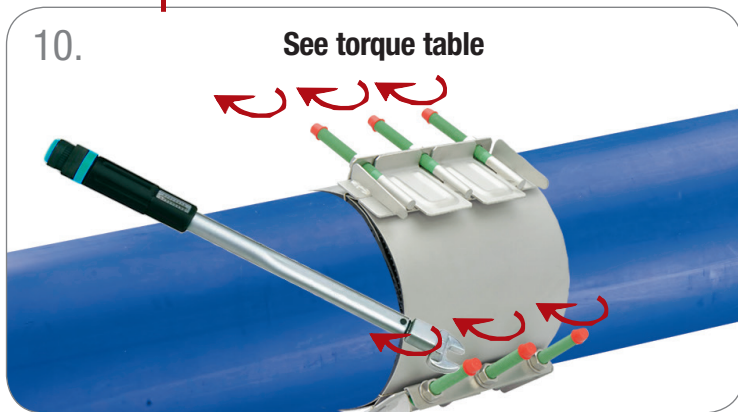

Repair clamp type FS30 Series 748/03, 748/23, 748/33

Note: Not recommended for total break

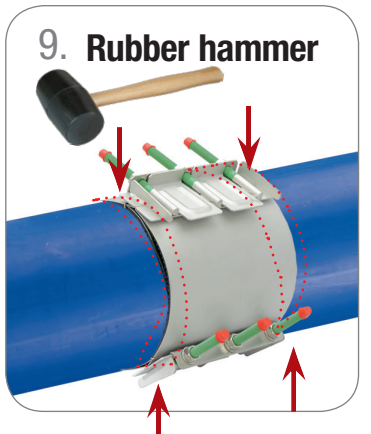
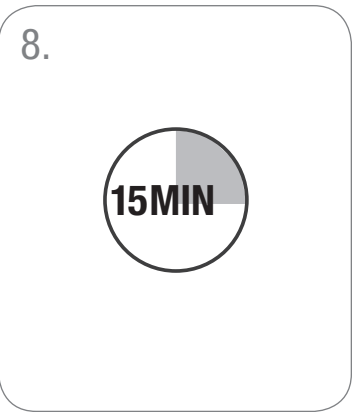
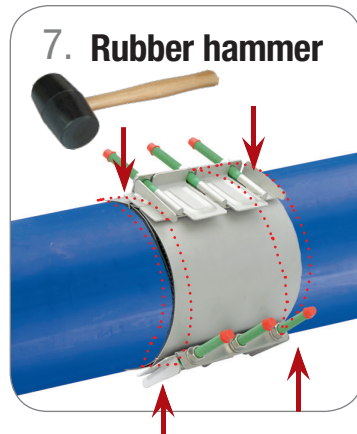
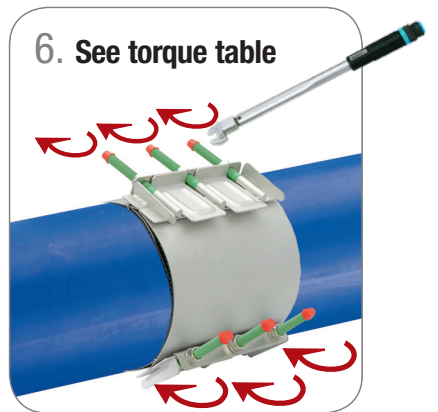
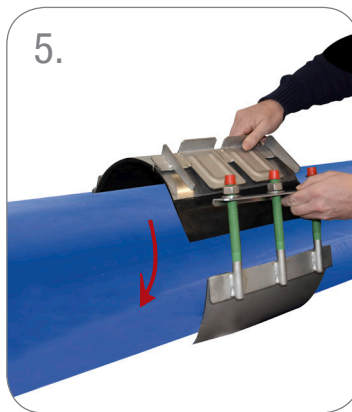
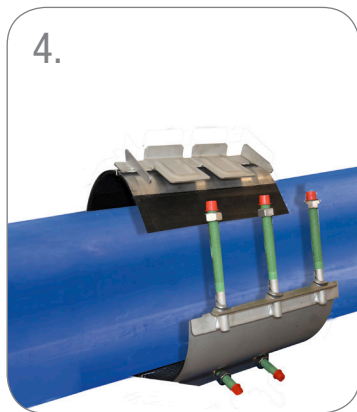
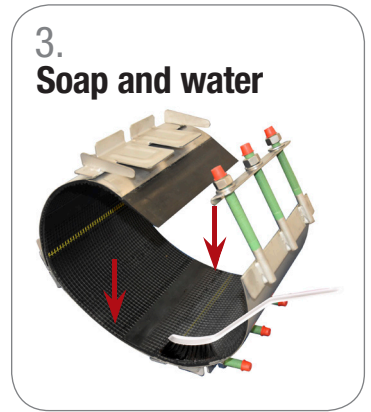
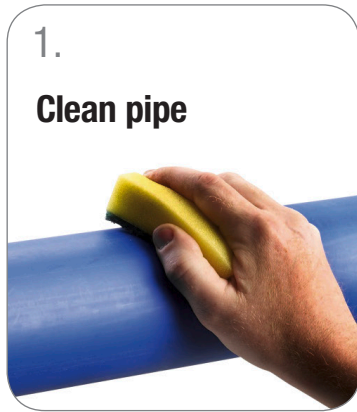

| Torque table | | |
|--|------------|--------|
| Bolts | Torque | Wrench |
| M14 | 70-90 Nm | 22 |
| M16 | 100-120 Nm | 24 |
| Recommendations: | | |
| - Use a rubber hammer, to improve rubber setting | | |
| - Turn nuts in steps of 20 Nm | | |
| - Cross tightening | | |